

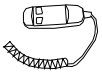

ASSEMBLY INSTRUCTIONS

CAUTION
PLEASE READ ALL INSTRUCTIONS
CAREFULLY BEFORE STARTING
ASSEMBLY PROCESS
IT IS RECOMMENDED TWO PEOPLE
WORK TOGETHER WHILE ASSEMBLING
THIS FURNITURE

PARTS LIST					
HAND CONTROL		1 PIECE	POWER		1 PIECE

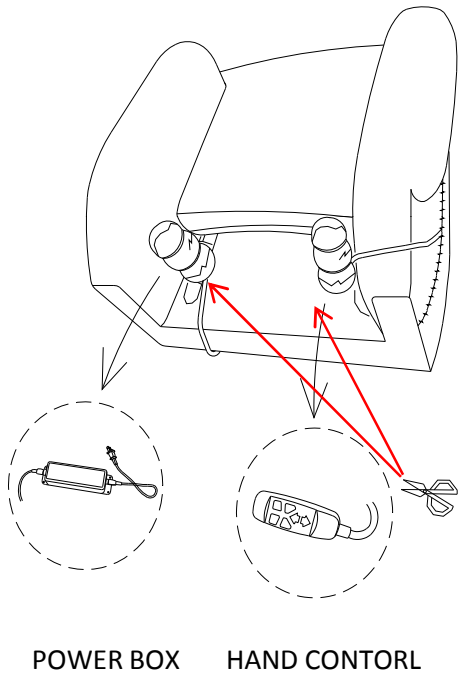

ASSEMBLY Step#1

THE HAND CONTROL AND POWER BOX ARE ATTACHED TO THE HARDWARE MALE BRACKET BEHIND THE REAR OF SEAT AS SHOWN ON PICTURE. PLEASE ONLY CUT THE PLASTIC TIE OF TWO PARTS AND REMOVE IT.

STEP#2
SLIDE THE METAL RECEIVERS OVER THE METAL POSTS (FIGURE A). PAY CLOSE ATTENTION TO THE ALIGNMENT OF THE RECEIVERS AND POSTS IN ORDER TO ENSURE A PROPER CONNECTION.
PRESS BOTH SIDES OF FIRMLY INTO PLACE. THE BACK SHOULD AUTOMATICALLY LOCK INTO PLACE.

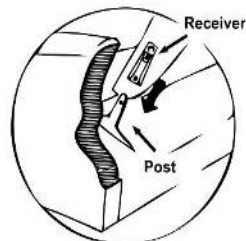

Figure A
(Figure A)

APPLY THE WINGS
INSERT THE MALE KD BRACKET INTO THE SLOT OF THE FEMALE BRACKET PRESSING FIRMLY DOWNWARD UNTIL THE FRAME IS TIGHT.

